

EX-54

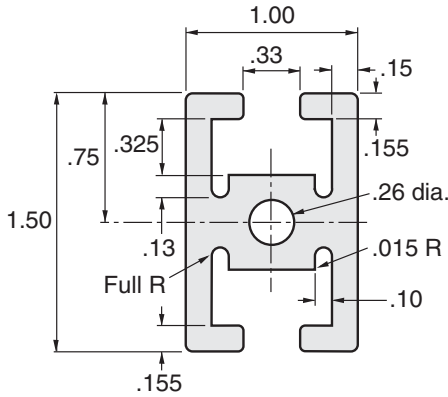

- Finish = Clear anodized
- Material = 6105-T5 Aluminum
- Est. Area = .840 Sq. In.
- Weight/ft = 1.008 lbs.
- 96", 192.63" Lengths standard.



Section Properties:

Moment of Inertia in ⁴	0.142	0.100
Section modulus in ³	0.189	0.200

Load condition:
Fixed at both ends, load at center
Deflection = y (inches)

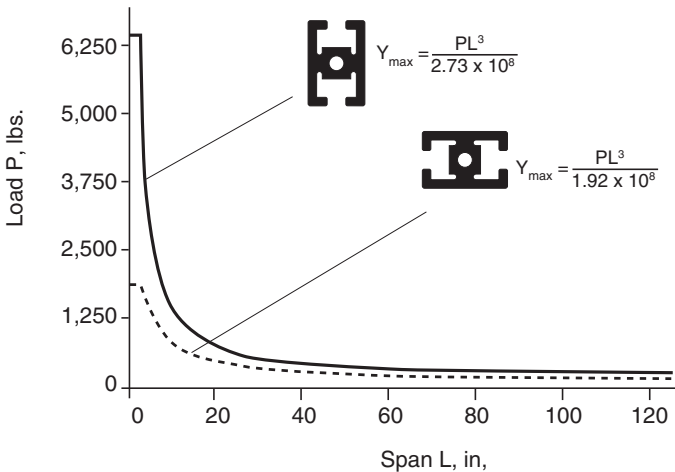
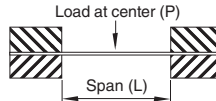

TECHNICAL

EX-54

Load condition:
Fixed at one end, sliding at one end,
load at center
Deflection = Y (inches)

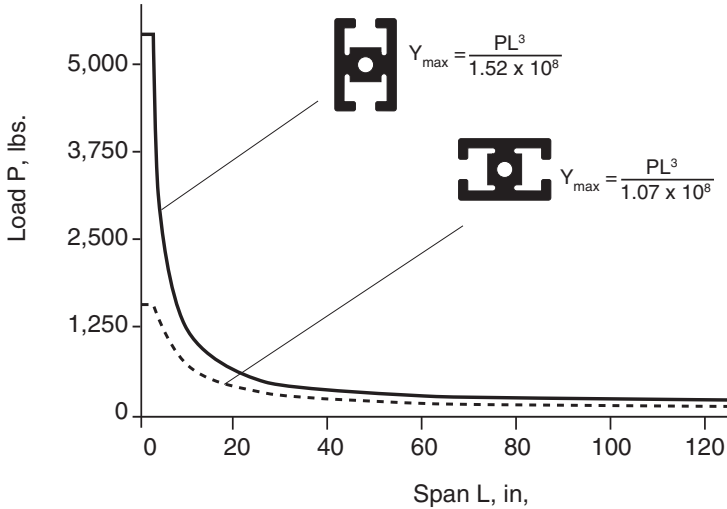
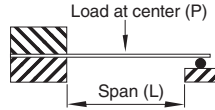

Load condition:
Fixed at one end,
load at unsupported end
Deflection = Y (inches)

