

**EX-23**

**SMOOTH-Series**

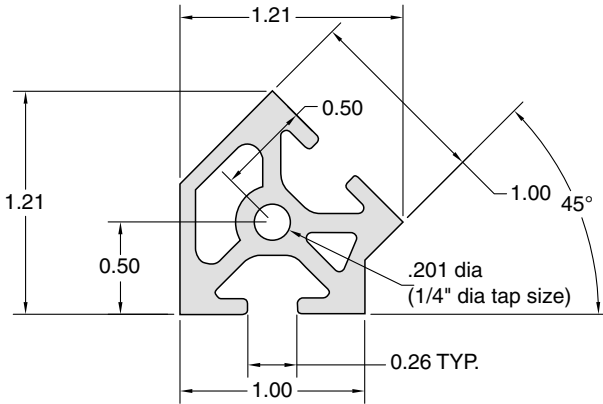

- Finish = Clear anodized
- Material = 6105-T5 Aluminum
- Est. Area = .52 Sq. In.
- Weight/ft = .61 lbs.
- 96", 192.63" Lengths standard.



**Section Properties:**

Moment of Inertia in <sup>4</sup>	.06	.05
Section modulus in <sup>3</sup>	.09	.06

**EX-28**

**SMOOTH-Series**

**1/4" SLOTS**

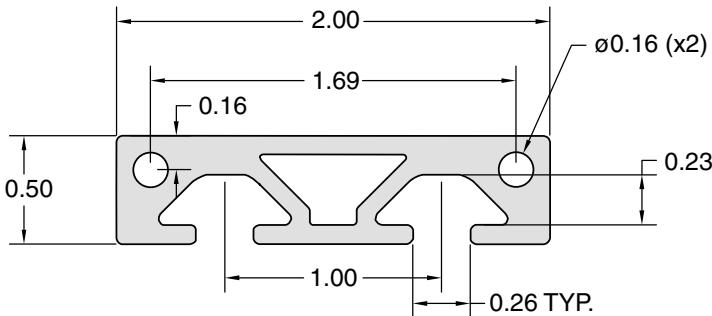

- Finish = Clear anodized
- Material = 6105-T5 Aluminum
- Est. Area = .58 Sq. In.
- Weight/ft = .67 lbs.
- 96", 192.63" Lengths standard.



**Section Properties:**

Moment of Inertia in <sup>4</sup>	.23	.02
Section modulus in <sup>3</sup>	.23	.06