

11-458

Fractional
(1/4" - 18 thd)

L = inch

11-458-.38

11-458-.50

11-458-.63

11-458-.75

11-458-1.00

11-458-1.25

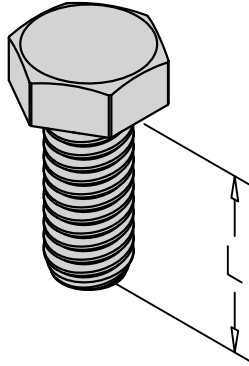

Metric

(M6 x 1.0 thd)

L = mm

11-458M-12

11-458M-16

11-458M-20

11-458M-25

11-458M-30

Material - Steel

Finish - Bright Zinc Plated

Material - Steel

Finish - Yellow Zinc Plated

Flat Head Socket Cap Screws

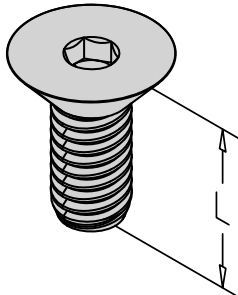

5/16-18 thd.

EF-156

1/4-20 thd.

EF-157

#10-32 thd.

EF-158

Steel

(1/4" - 20 thd)

L = inch

EF-157-.50

EF-157-.63

EF-157-.75

EF-157-.88

EF-157-1.0

Stainless Steel

(1/4" - 20 thd)

L = inch

EF-157SS-.50

EF-157SS-.63

EF-157SS-.75

EF-157SS-.875

(#10-32 thd)

L = inch

EF-158SS-.38

EF-158SS-.50

EF-158SS-.63

EF-158SS-.75

EF-158SS-1.0

Metric

(m8 x 1.25 thd)

stainless steel

FM8-16-SS

FM8-20-SS

(m6 x 1.0 thd) steel

FM6-12

FM6-14

FM6-16

FM6-20

FM6-25

FM6-30

FM6-40

(m6 x 1.0 thd)

stainless steel

FM6-12-SS

FM6-14-SS

FM6-16-SS

1/4" SLOTS